

Pancake junction box cover with two screw mount holes. Utilized for junction mount installations.

- Machined aluminum construction.
- Seven standard TGIC powder coat finishes and clear anodized finish available.
- Mounting hardware not supplied
- 1/2" NPS threaded canopy accepts industry standard luminaires.
- Two 3/16" screw mount holes.
- CSA listed for wet location landscape use (UL1838).
- Warranty: 10 Years.

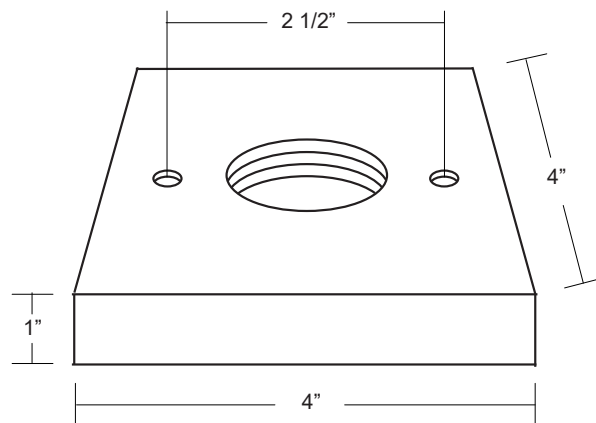

## Specifications

MODEL: MT-23  
 MATERIAL: Machined Aluminum  
 MOUNTING: 1/2" NPS mount threads

FINISHES: BK - Black BKT - Black Texture  
 BZ - Bronze BZT - Bronze Texture  
 WT - White SL - Silver  
 BG - Beige CA - Clear Anodized

## Ordering Logic:

MODEL	METAL	FINISH	
MT - 23	A - Aluminum	BK- Black BZ - Bronze WT - White BG - Beige	BKT - Black Texture BZT- Bronze Texture SL - Silver CA - Clear Anodized

ORDERING EXAMPLE: MT - 23 - A - BK

Excelsior Lighting, Inc.

PROJECT

TYPE