

Specification-grade landscape lighting, wet-location luminaire for up lighting or down lighting applications. Can be utilized for ground mounted or surface mounted installations.

- Machined 6061-T6 copper-free aluminum. Aluminum components are black anodized, then a polyester powder coat finish is applied.
- Seven standard TGIC powder coat finishes and clear anodized finish available.
- Stainless steel hardware.
- Three interchangeable reflector optics included.
- Three cap styles from which to choose.
- Two mounting options: Ground or surface.
- Side mount knuckle design.
- Clear tempered glass lens, glued in.
- High-temperature silicone O-ring seal used to seal the cap against the body.
- Listed for wet location use.
- Warranty: 10 Years (fixture).

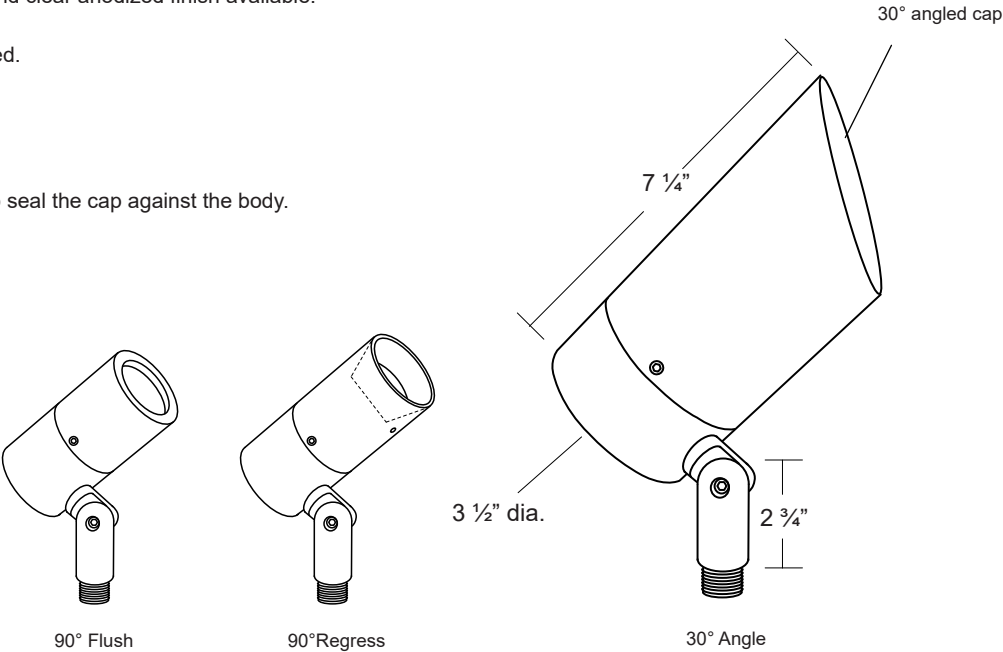

Specifications

MODEL: AL - 40L
MATERIAL: 6061-T6 Aluminum
VOLTAGE: 120V-277V
WATTAGE: 8W, 16W, 31W

Interchangeable optics supplied with luminaire.

OPTICS: SP - 20° Spot
FL - 42° Flood
WFL - 60° Wide Flood
KELVIN: 2700, 3000, 3500, 4000

Ordering Logic:

MODEL	CAP STYLE	MOUNT	FINISH	
AL - 40L	1 - 90° Flush	MT48 - Ground mount	BK - Black	BKT - Black Texture
	2 - 90° Regress	MT49 - Surface mount	BZ - Bronze	BZT - Bronze Texture
	3 - 30° Angle	MT50 - Tree mount	WT - White	SL - Silver
			BG - Beige	CA - Clear Anodized

ORDERING EXAMPLE: AL - 40L - 1 - MT48 - BZT - 643*

*See specification sheet to select lamp type to be installed.

Excelsior Lighting, Inc.

PROJECT:

TYPE:

Xicato XTM LED Modules with Corrected Cold Phosphor Technology

- Flux packages from 700lm to 2000lm.
- CCT range from 2700K to 4000K.
- Integrated DC driver electronics.
- Efficacy up to 99 lm/W.
- Very tight color consistency, within 1x2 MacAdam ellipses initially and 3 MacAdam ellipses after 50,000 hours.
- A verifiable 50,000 hour/7 year operational warranty.
- Warranty: 5 Years



XTM SERIES



C.O.B LED MODULE OPTIONS

	XTM MODULE	COLOR
700 LUMENS 8 watts	640	2700K
	641	3000K
	642	3500K
	643	4000K
1300 LUMENS 16 watts	644	2700K
	645	3000K
	646	3500K
	647	4000K
2000 LUMENS 31 watts	648	2700K
	649	3000K
	650	3500K
	651	4000K
3000 LUMENS 31 watts	652	2700K
	653	3000K
	654	3500K
	655	4000K



20° Spot



42° Flood



60° Wide Flood

INTERCHANGEABLE OPTICS

Machined aluminum cap with PVC stake for ground-mounting. Designed for mounting single luminaire for ground mount installation of LED driver.

- Machined aluminum cap.
- 120-277 VAC driver
- Dimmable driver included for use with standard incandescent dimmers. 10-100% range: 8W, 16W or 31W (specify)
- Seven standard TGIC powder coat finishes and clear anodized finish available.
- 3X 1/2" Slip conduit connectors.
- PVC stake lengths: 12" or 18".
- Listed for wet location use.
- Warranty: Mounting - 10 years
Driver - 5 years

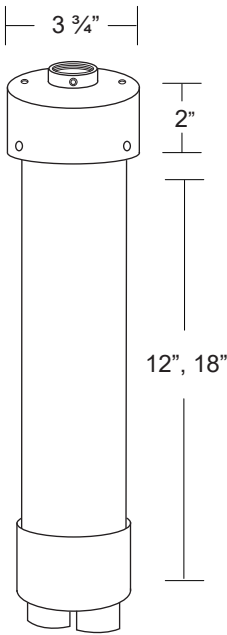

Specifications

MODEL:	MT-48	VOLTAGE:	120-277 VAC Input
MOUNTING:	1/2" NPS		

Ordering Logic:

MODEL	METAL	STAKE LENGTH	DIMMABLE DRIVER	CAP FINISH	
MT - 48	A - Aluminum	12 - 12" 18 - 18"	8 - 8W	BK - Black	BKT - Black Texture
			16 - 16W	BZ - Bronze	BZT - Bronze Texture
			31 - 31W	WT - White	SL - Silver
				BG - Beige	CA - Clear Anodized

ORDERING EXAMPLE: MT - 48 - A - 12 - 8 - BZ

Excelsior Lighting, Inc.	PROJECT
	TYPE

Machined powered surface mount with cover. Designed for mounting a single luminaire for surface mount installation with LED driver.

- Machined aluminum construction.
- 120-277 VAC driver.
- Dimmable driver included for use with standard incandescent dimmers. 10-100% range:
8W, 16W or 31W (specify)
- Seven standard TGIC powder coat finishes and clear anodized finish available.
- Two 7/8" slip holes. Accepts industry standard conduit connectors.
- Fits onto 4/0 standard J-Box.
- Listed for wet location use.
- Warranty: Mounting - 10 years
Driver - 5 years

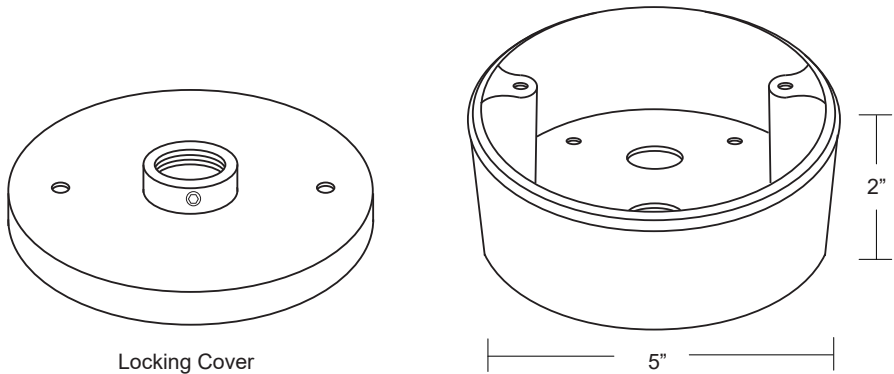

Specifications

MODEL:	MT-49	VOLTAGE:	120-277 VAC Input
MATERIAL:	Machined Aluminum		
MOUNTING:	#10 screw mount holes (4X)		

Ordering Logic:

MODEL	METAL	DIMMABLE DRIVER	FINISH	
MT - 49	A - Aluminum	8 - 8W 16 - 16W 31 - 31W	BK- Black BZ - Bronze WT - White BG - Beige	BKT - Black Texture BZT - Bronze Texture SL - Silver CA - Clear Anodized

ORDERING EXAMPLE: MT - 49 - A - 8 - BK

Excelsior Lighting, Inc.

PROJECT

TYPE

POWERED BOX MOUNT with TREE STRAP

120-277VAC

MODEL MT-50

Cast aluminum box and cover with strap for tree mounting. Designed for mounting single luminaire for tree mount installation of LED driver and fixture.

- Cast aluminum junction box.
- Dimmable driver included for use with standard incandescent dimmers. 10-100% range: 8W, 16W, 31W (specify).
- Single mount cover included.
- Seven standard TGIC powder coat finishes.
- Stainless steel ratchet and hook powder coated bronze texture finish.
- Strap lengths of 48", 72" or 120".
- 1/2" NPS mount for use with FA-40L and AL-40L series only.
- UL listed for wet location use.
- Warranty: Mounting - 10 Years.
Driver - 5 years

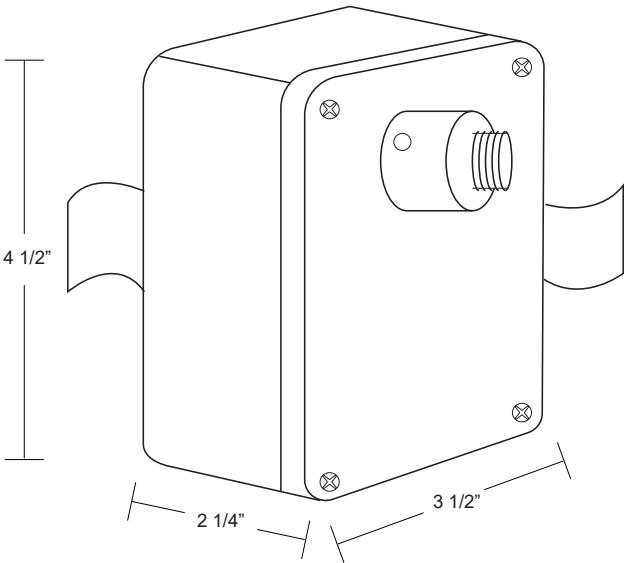

Specifications

MODEL:	MT-50	VOLTAGE:	120 - 277 VAC Input
MATERIAL:	6061-T6 Aluminum		
MOUNTING:	1/2" NPS		

Ordering Logic:

MODEL	METAL	BOX QUANTITY	DIMMABLE DRIVER	STRAP LENGTH	FINISH	
MT - 50	A - Aluminum	1 - One	8 -8W	48 - 48"	BK- Black	BKT - Black Texture
		2 - Two	16 - 16W	72 - 72"	BZ - Bronze	BZT- Bronze Texture
			31 - 31W	120 - 120"	WT - White	SL - Silver
					BG - Beige	

ORDERING EXAMPLE: MT - 50 - A - 1 - 8 - 72 - BZ

Excelsior Lighting, Inc.	PROJECT
	TYPE

The Cielo series of LED drivers generate one constant current output from an AC input.

- 120-277 VAC Input
- Dims with TRIAC and ELV dimmers at 120 VAC only
- Dims with industry standard 0-10V dimmers (108-305 VAC)
- Max Output Power: 10W to 50W
- Efficiency up to 84%
- 90°C Top case rated
- <20% THD, >0.9 PF
- Fast start up time
- UL 8750 Approved, UL LED Class 2 outputs
- Class II isolation
- Long Life
- RoHS Compliant



The modules operate with:

- Standard light switches
- 0 - 10V Dimmers
- Triac based Incandescent Dimmers (Forward phase - leading edge)
- Electronic Low Voltage Dimmers (Reverse phase - trailing edge)

Wiring Diagram - 0 -10V

