

Specification-grade wet-location luminaire for wall mount applications.

- Machined 6061-T6 copper-free aluminum. Aluminum components are black anodized, then a polyester powder coat finish is applied.
- Seven standard TGIC powder coat finishes and clear anodized finish available.
- Remote transformer required.
- Stainless steel hardware.
- 10" 18ga. Teflon coated wire leads.
- 30° angled lens cap holds 3 lens accessories.
- Clear tempered glass lens, glued in.
- High-temperature silicone O-ring seal used to seal the cap against the body.
- Molded silicone wire pass-thru attached to socket wire prevents wicking and water leaking into the lamp compartment.
- Listed for wet location use.
- Warranty: 10 Years.

Mounting Plate Options:

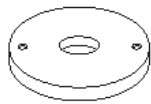

4/0 Round  
5" dia.

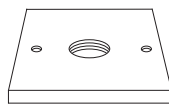

4/0 Square  
5" Square

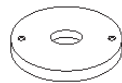

3/0 Round  
4" dia.

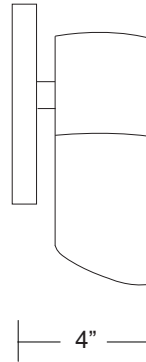

4"

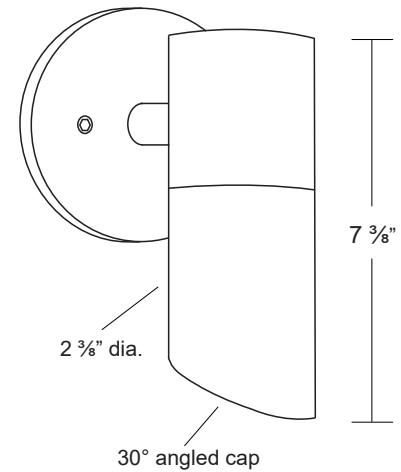

2 3/8" dia.

30° angled cap

7 3/8"



## Specifications

MODEL:	WA-6	LAMPING:	MR16 Halogen, 50W Maximum (order separately) 8W LED (order separately)	
MATERIAL:	6061-T6 Aluminum	FINISHES:	BK - Black	BKT - Black Texture
VOLTAGE:	12V		BZ - Bronze	BZT - Bronze Texture
WATTAGE:	50 watt, 8 watt LED		WT - White	SL - Silver
SOCKET:	GY-6.35 Bi-pin porcelain socket rated 600V, 250°C 18 ga, Teflon® coated leads.		BG - Beige	CA - Clear Anodized

## Ordering Logic:

MODEL	METAL	MOUNTING PLATE		FINISH	
WA - 6	A - Aluminum	1 - 4/0 Round 3 - 3/0 Round	2 - 4/0 Square	BK - Black BZ - Bronze WT - White BG - Beige	BKT - Black Texture BZT - Bronze Texture SL - Silver CA - Clear Anodized

ORDERING EXAMPLE: WA - 6 - A - 1 - BK

Excelsior Lighting, Inc.

PROJECT

TYPE